

# High-brightness Lighting BOX 《LLBG Series》

High-brightness lighting box

## LLBG Filter Changer

Light source box with a filter changer



Model	LLBG1-ZAF2 (Old Model: LLBG1-ZAF)
Recommended bundle diameter	φ3~20mm
Outer dimensions W×D×H [mm]	145×270×195
Lighting system	Constant-current control
Number of outputs	1ch
Input power	100 VAC to 240 VAC (±10%)
Power consumption	160W (typ)
LED service life	Min. 30,000 hours*1
Applicable fiber	Glass fiber
Cooling system	Fan cooling. Front intake and rear exhaust (one internal fan and one rear fan)
LED emission color	White
Color filter	Up to 6 filters can be attached.
External interface	Parallel/RS-232C/LAN ports (standard equipment)
Mass	Approx. 4.8 kg
Environmental control	Conforming to RoHS2

\*1 Estimated value based on range from initial light intensity to 70% (This value is not guaranteed.)



LAN

RS-232C

Fan cooling

Customizable

Emission color

### Features

- This filter changer can be installed on a high-power light source box exceeding a 250 W metal halide light source.
- Up to 6 color filters can be attached.
- External interface: Parallel/RS-232C/LAN ports (standard equipment)
- Proprietary cooling mechanism ensures stable light output.
- Mounting adapter selectable according to light guide used.

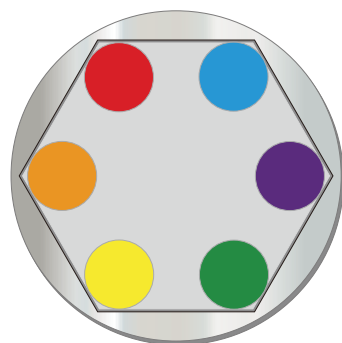

Up to 6 color filters can be attached.

### Application example

- Light source for various light guides, light source for transmission light
- Light source for line camera, light source for area camera
- Light source for visual inspection, light source for image processing

### Outer dimensions

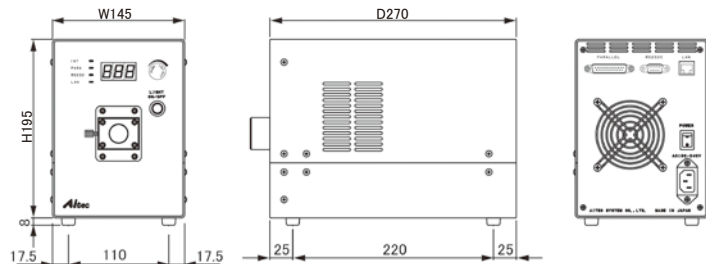

\* Product specifications are subject to change without notice.

### Data (Typical example)

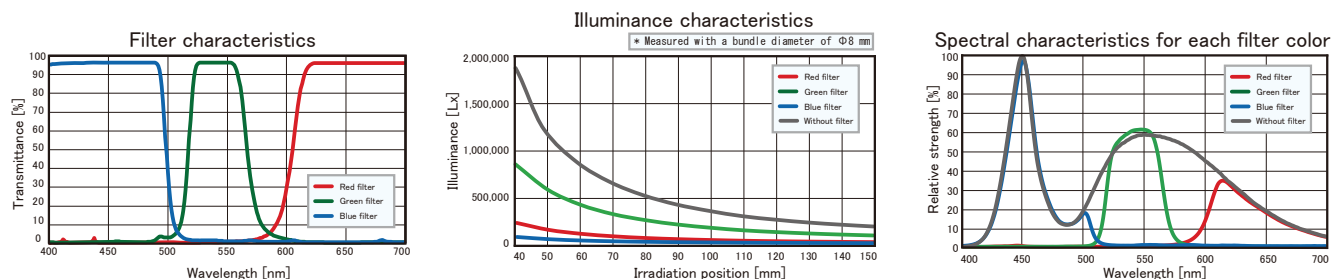

\* Graph information (for reference only) does not guarantee product quality.

# Options

## ALU54- Condensing Lens Unit



Customizable

### Outer dimensions

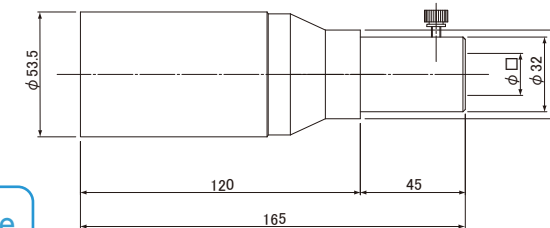

\* Product specifications are subject to change without notice.

### Use and features

- Condenser lens dedicated to large bundle diameters
- Supports bundle diameters φ12 mm to 20 mm
- Attaching this unit to a lighting box allows for increased/more uniform illuminance on the irradiation surface
- Contact us about the mounting diameter on the condenser lens side. (Outer dimensions: □)
- This unit is used for various purposes such as image processing and visual inspection.

### Data (Typical example : ALU54-18, LLBG1-BA)

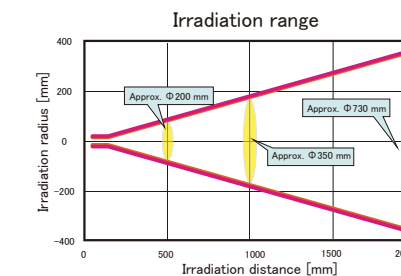
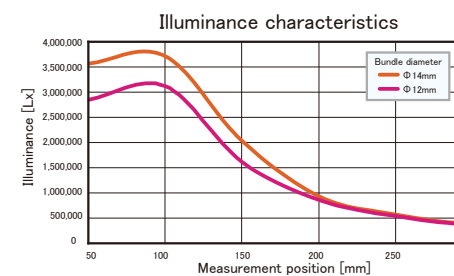

\* Graph information (for reference only) does not guarantee product quality.

## Light Guide (Optical Fiber)



Customizable

### Use and features

- Attaching this light guide to a lighting box allows for various lighting applications.
- Various fiber materials (including plastic and glass) available
- Custom-orderable light guide for specific applications. Various uses, such as inspection

### Elements of model

GL □ □ □ □ - □ □ - □ □ □ □

### Model examples: GLP8IE-1S-1M-YR

- ① Plastic fiber ② Bundle diameter φ8 mm ③ Fixed tube ④ Insertion part φ15 mm x 37 mm
- ⑤ 1-branch fiber ⑥ Straight bracket ⑦ Fiber length 1 m ⑧ Fiber exit size φ12 mm x 20 mm
- ⑨ End shape: Circle

① Material	② Bundle diameter	③ Exterior tube	④ Light guide insertion part	⑤ Branch	⑥ Shape of incident-side bracket	⑦ Length	⑧ Fiber exit size	⑨ Fiber end shape
P: Plastic	3:φ3	I: Fixed type	Blank: Dedicated type	1: 1-branch fiber	S: Straight	1M:1m	U: φ25 mm x 40 mm (bundle diameter φ20 mm)	R: Ring
G: Multi-component glass	4:φ4	F: Flexible type	A: φ25 mm x 40 mm (for bundle φ20 mm diameter) fiber insertion part outer diameter φ25 mm x insertion length 40 mm	2: 2-branch fiber	R: Right angle	R5M:0.5m	V: φ18 mm x 40mm (bundle diameter φ14 mm)	L: Linear
Q: Quartz	5:φ5		E: φ15 mm x 37 mm (MORITEX) fiber insertion part outer diameter φ15 mm x insertion length 37 mm	4: 4-branch fiber			W: φ14 mm x 40mm (bundle diameter φ8 to 12)	No symbol: Straight spot
	6:φ6		F: φ15 x 31 (NIPPON P.I. NISSEI ELECTRIC, Kenko Tokina, HOYA) fiber insertion part outer diameter φ15 x insertion length 31 mm				X: φ5 mm x 30 mm (bundle diameter φ3 mm)	
	8:φ8		G: φ15 x 21 (MITSUBISHI BAYON) fiber insertion part outer diameter φ15 x insertion length 21 mm				Y: φ12 mm x 20 mm (bundle diameter φ4 mm to 6 mm)	
	10:φ10		H: φ15 x 20 (HAYASHI WATCH-WORKS) fiber insertion part outer diameter φ15 x insertion length 20 mm				Z:φ8x12	
	11.3:φ11.3		I: φ20 x 15 (for bundle φ14 diameter) fiber insertion part outer diameter φ20 x insertion length 15 mm					
	12:φ12		J: φ13 x 15 (SUMITA OPTICAL GLASS) fiber insertion part outer diameter φ13 x insertion length 15 mm					
	14:φ14		S: φ15 mm x 15 mm (standard) fiber insertion part outer diameter φ15 mm x insertion length 15 mm					
	20:φ20							